

**Keyplan**  
Scale @ 1 : 500

Note:  
All existing information shown is based upon a survey model provided by the client. In some instances existing information was not available and has been estimated.  
All proposed information shown is subject to review by the following consultants (let not exhaustive): Structural Engineer, M&E Engineer, Building Control, Fire Engineer, Acoustician, Planning Consultant, Local Authority, Statutory Consultants.

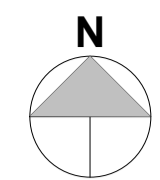

Scale	TO BE USED ONLY AS GUIDANCE
1:100	mm
1:200	mm
1:500	M
1:1250	M

- NOTES**
- All dimensions and levels are to be checked on site.
  - Any discrepancies are to be reported to the architect before any work commences.
  - This drawing shall not be scaled to ascertain any dimensions. Work to figured dimensions only.
  - This drawing shall not be reproduced without express written permission from AEW.
  - Title overlay drawings and ownership boundaries are produced using all reasonable endeavors. AEW cannot be responsible for the accuracy or scale discrepancy of base plans supplied to them.
  - All works are to be undertaken in accordance with Building Regulations and the latest British Standards.
  - All proprietary materials and products are to be used strictly in accordance with the manufacturers recommendations.
- This drawing contains the following model files:-  
12905-AEW-XX-XX-M3-A-0001

**CDM 2015**  
Client notified of duties: 11/04/22  
Principal Designer: TBC

Unless noted below, all known hazards have been highlighted on the drawing.

**Key**

- Current Project Boundary
- Existing Structure
- Existing Structure (assumed - subject to further survey)
- Area not surveyed internally
- Proposed New Structure
- Proposed New Floor Area
- Not in project scope

**Proposed Uses**

- Library (Dedicated)
- DWP (Dedicated)
- Council Services (Dedicated)
- Communal Hub Services (Shared)

Furniture arrangements and specifications shown indicatively only - awaiting client/ stakeholder FFE audit information. Furniture arrangements, details and quantities subject to further development by designer.

Rev	Date	Description	Drawn by	Checked by
P04	06/07/23	Updated to library feedback call	PC	LD
		- door added to store room		
		- shelving adjusted to suit		
P03	23/06/23	Layouts & areas updated following client meeting	MH	LD
		22/06/23		
P02	15/06/23	Areas / layout updated following client meeting following WCC meetings	MH	LD
		14/06/23		
P01	28/04/23	Initial Issue	MH	LD
Rev	Date	Description	Drawn by	Checked by
S2		For information		

drawing stage: **Stage 3**  
client: **Redditch & Bromsgrove Borough Council**  
project: **Redditch Town Hall**  
drawing title: **Proposed GA Ground Floor Plan (Stage 3)**  
date: 27/03/23 drawn: MH  
scale @ A1: As indicated checked: LD

**00 - Proposed GA Ground Floor Plan (Stage 3)**  
Scale @ 1 : 100

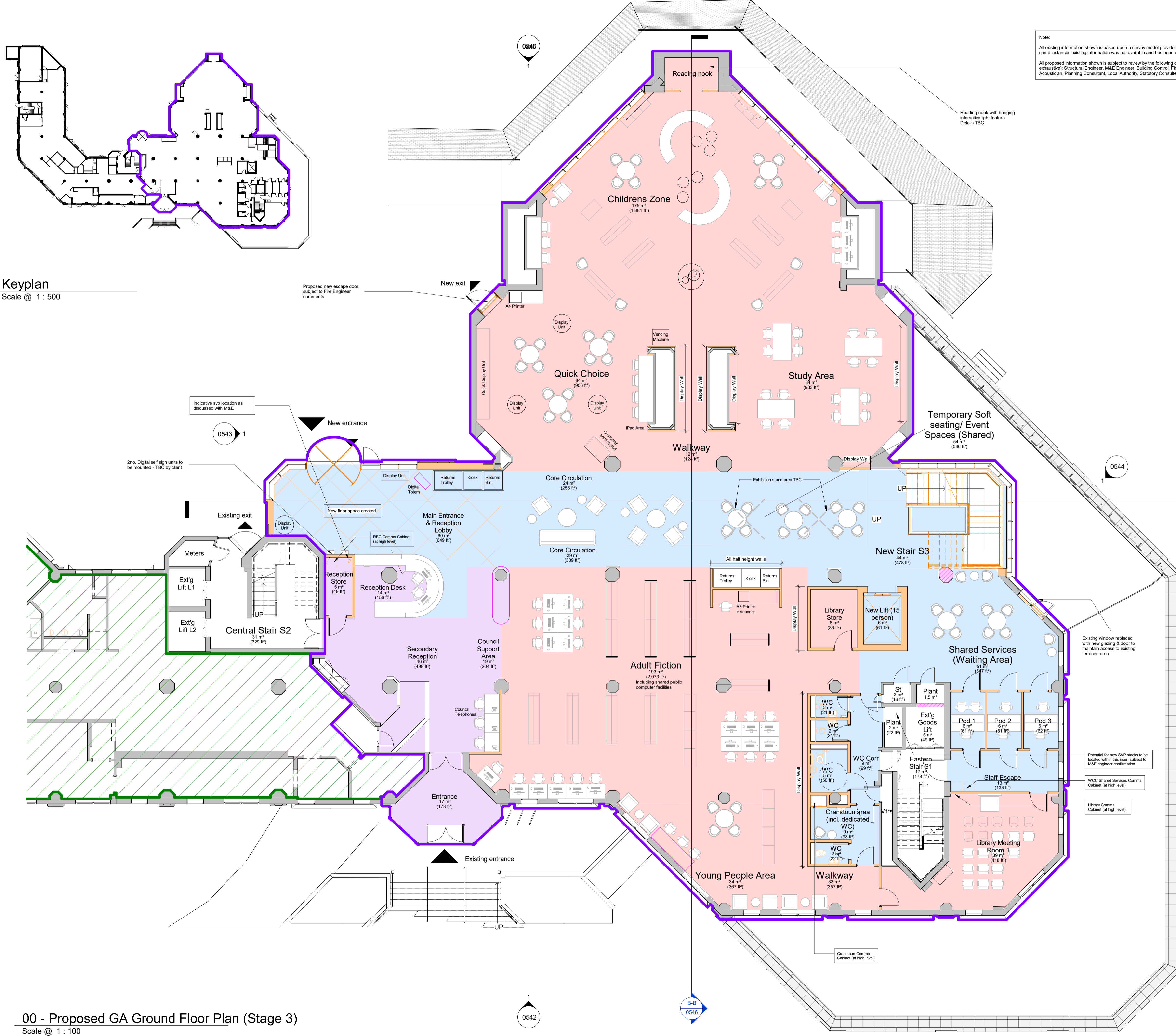

Row **P04**  
 Draw No **12905-AEW-XX-XX-DR-A-0651**  
 aew architects  
 0161 214 4370  
 www.aewarchitects.com  
**aeW**